

■ External Option : Compact Electric Power Transmission

Extensible Options :
Resin Connector, Solder Terminal

Master Cylinder
model SWLZ0K0-M

Tool Adapter
model SWLZ0K0-T



● Specifications

Rated Value (per contact)		AC/DC 200V 5A
Total Current Capacity		12A
Number of Poles (per electrode)		4
Weight ※1	Master Cylinder Side	Electrode 17g
	Tool Adapter Side	Electrode 13g
Cable with Applicable Terminal (Sold Separately)		SWZ0K0-CL□ -CL1 : 1m, 61g -CL2 : 2m, 126g

※1. Weight per electrode.

● Extensible Options Additional electrode can be extended.

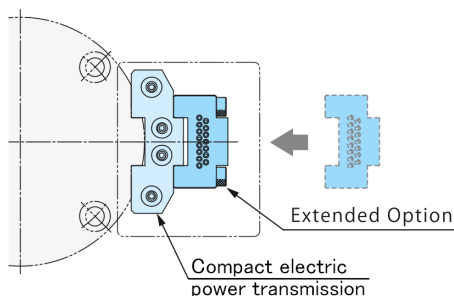

Expandable optional explode	Main unit type				
	KWRY 0010	KWR 0070	KWR 0120	KWR 0250	KWR 0500
SWRZ0J0-□: Resin connector	●	●	●	●	●
SWLZ0C0-□01/02: Solder terminal with cable	●	●	●	●	●

Please contact us for detailed dimensions for expansion.

● Applicable Cable

The cable with applicable terminal and applicable terminal are not included.

Please prepare the cable with applicable terminal (SWZ0K0-CL□) or design it yourself referring to the applicable terminal.

● External Dimensions (KWR0070/KWR0120/KWR0500)

Master Cylinder Side				Tool Adapter Side			
Model No.	No.	Name	Quantity	Model No.	No.	Name	Quantity
SWLZ0K0-M	①	Electrode (Master Side)	1	SWLZ0K0-T	⑤	Electrode (Tool Side)	1
	②	Parallel Pin $\phi 1.5 \times 4$ B Type (SUS)	2		②	Parallel Pin $\phi 1.5 \times 4$ B Type (SUS)	2
	③	Bolt Cover	1		③	Bolt Cover	1
	④	Hexagon Socket Bolt M3×0.5×16 (SUS)	2		④	Hexagon Socket Bolt M3×0.5×16 (SUS)	2

Notes : 1. The electrode probe on master side strokes 1.5mm (※2) when connecting with KWR.

When fixing the cable, make sure there is enough space for the probe operation.

2. The electrode stays connected when released, because its connecting stroke requires 1.5mm which is longer than KWR lift stroke.

※3. The optional cable and terminal are not included in the electrode. Please prepare them separately.

● External Dimensions (KWR0010)

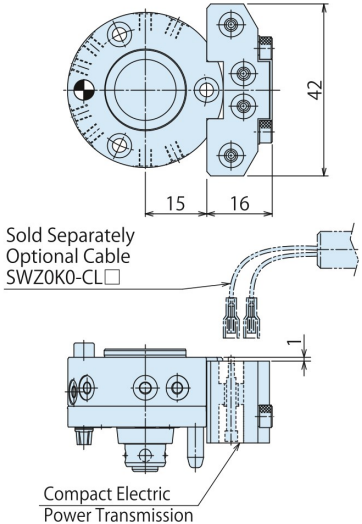
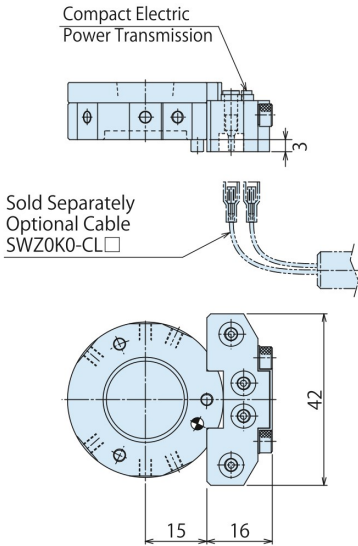
Master Cylinder Side				Tool Adapter Side			
							
Model No.	No.	Name	Quantity	Model No.	No.	Name	Quantity
SWLZ0K0-M	①	Electrode (Master Side)	1	SWLZ0K0-T	⑤	Electrode (Tool Side)	1
	②	Parallel Pin $\phi 1.5 \times 4$ B Type (SUS)	2		②	Parallel Pin $\phi 1.5 \times 4$ B Type (SUS)	2
	③	Bolt Cover	1		③	Bolt Cover	1
	④	Hexagon Socket Bolt M3×0.5×16 (SUS)	2		④	Hexagon Socket Bolt M3×0.5×16 (SUS)	2

- Notes : 1. The electrode probe on master side strokes 1.5mm (※2) when connecting with KWR.
When fixing the cable, make sure there is enough space for the probe operation.
2. The electrode stays connected when released, because its connecting stroke requires 1.5mm which is longer than KWR lift stroke.
- ※3. The optional cable and terminal are not included in the electrode. Please prepare them separately.

● External Option : Cable with Terminal for Compact Electric Power Transmission

This cable is an optional cable applicable to the Compact Electric Power Transmission.

Model No. Indication

SWZ0K0-C

L1
L2

Cable Length
L1 : 1m
L2 : 2m

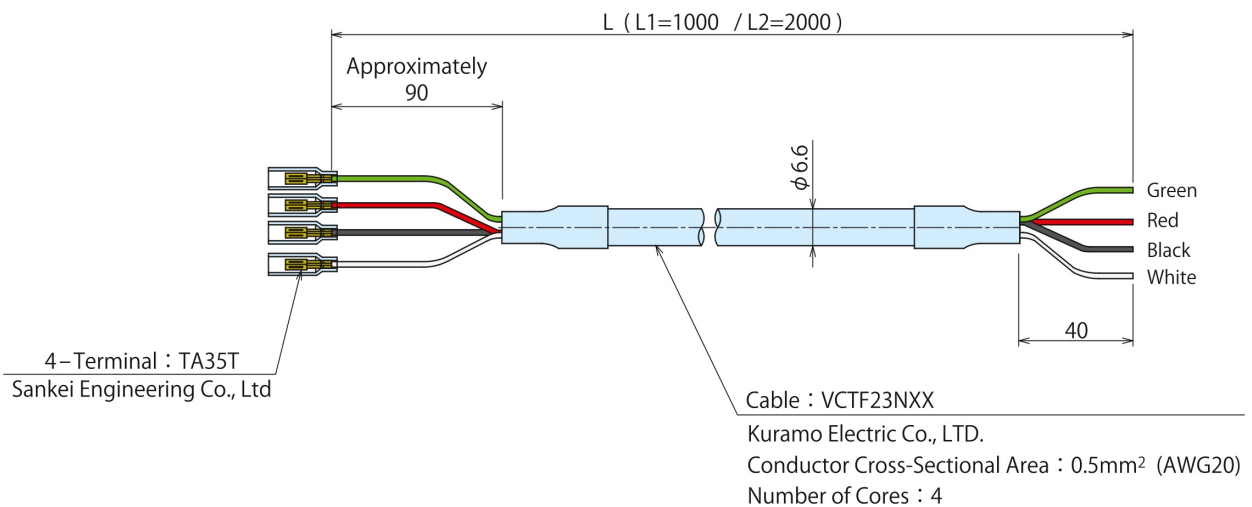

※ A crimp tool for crimping the applicable terminal (TA35T) is required when preparing a cable by yourself referring to this drawing.

【Notes on Wire/Cable Procedure and Wiring】

- Make sure to fix the wire and cable so that they are not pulled while a robot is moving or turning around.
External force should not be applied on the connector part since it leads to breaking of wire, detaching of connector and contact failure.
However, the electrode probe on master side strokes 1.5mm when connecting with KWR. When fixing the cable, make sure there is enough space for the probe to stroke.

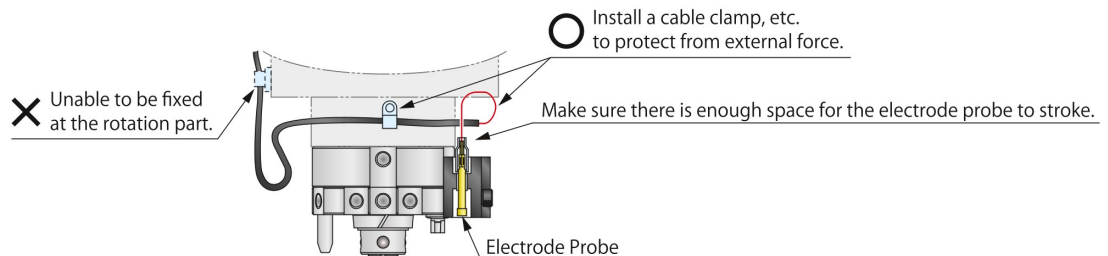

- As for Compact Electric Power Transmission option, the electrode probes on both master cylinder and tool adaptor are exchangeable.
The electrode probes will be fallen out if pushed from the cable connecting side with power stronger than a certain level.
In case the electrode probes are pushed out after connecting the cable, make sure to push them back from the seating surface side before use.