

External Option : Air Joint (3-Port Option (1 Port Rc1/8))

Extensible Options :
Resin Connector, Solder Terminal

Master Cylinder
model SWRLZ0R0-M

Tool Adapter
model SWRLZ0R0-T

Specifications

Port Size	Rc1/8	M5	
Number of Ports	1	2	
Operating Pressure	KWR0070 or larger	max. 0.7MPa (Vacuum Available)	
	KWR0030	max. 0.5MPa (Vacuum Available)	
Withstanding Pressure	1.1MPa		
Min. Passage Area	28.3mm ²	3.1mm ²	
Operating Temperature	0 ~ 70°C		
Usable Fluid	Dry Air		
Reaction Force (per port)	Pressure at 0.7 MPa	0.13 kN	0.04kN
	Pressure at 0.5 MPa	0.10 kN	0.03kN
	Pressure at P MPa	0.154×P+0.019 kN	0.047×P+0.008 kN
Weight ※1	Master Cylinder Side	Air Joint 51g	
	Tool Adapter Side	Air Joint 25g	

※1. Weight per joint.

Extensible Options Additional electrode can be extended to this option

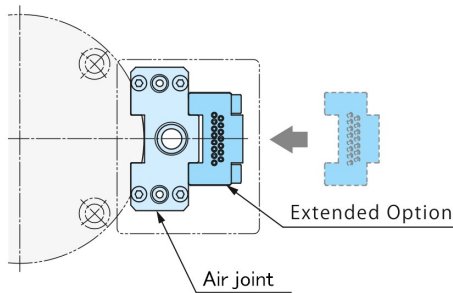

Expandable optional explode	Main unit type				
	KWRY 0010	KWR 0070	KWR 0120	KWR 0250	KWR 0500
SWRZ0J-□: Resin connector	N/A	●	●	●	●
SWLZ0C0-□01/02: Solder terminal with cable	N/A	●	●	●	●

Please contact us for detailed dimensions for expansion.

External Dimensions (KWR0070/KWR0120/KWR0250/KWR0500)

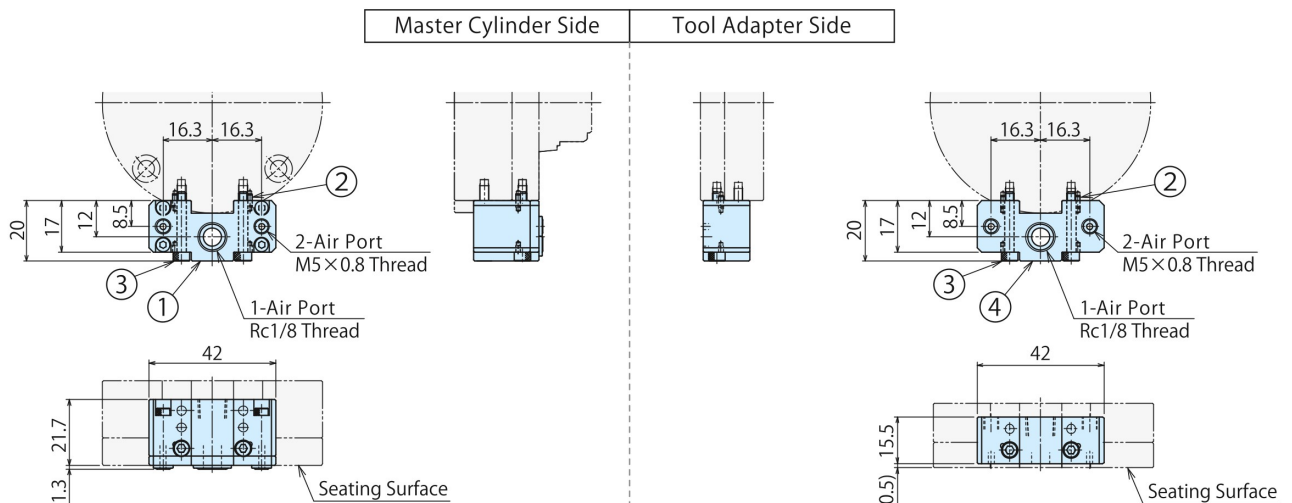

Model No.	No.	Name	Quantity
SWLZ0R0-M	①	Joint (Master Side)	1
	②	Parallel Pin $\phi 1.5 \times 4$ B Type (SUS)	2
	③	Hexagon Socket Bolt M3×0.5×20 (SUS)	2

Model No.	No.	Name	Quantity
SWLZ0R0-T	④	Joint (Tool Side)	1
	②	Parallel Pin $\phi 1.5 \times 4$ B Type (SUS)	2
	③	Hexagon Socket Bolt M3×0.5×20 (SUS)	2

● External Dimensions (KWR0010)

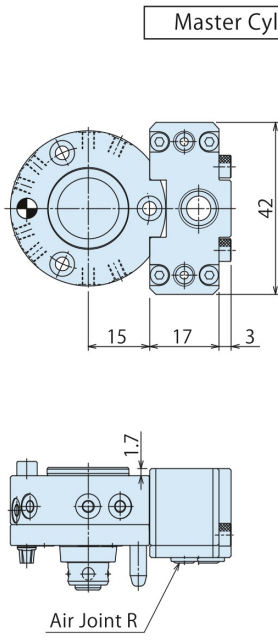

Model No.	No.	Name	Quantity
SWLZ0R0-M	①	Joint (Master Side)	1
	②	Parallel Pin $\phi 1.5 \times 4$ B Type (SUS)	2
	③	Hexagon Socket Bolt $M3 \times 0.5 \times 20$ (SUS)	2

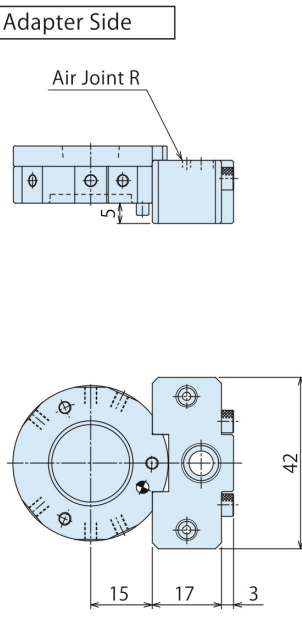

Model No.	No.	Name	Quantity
SWLZ0R0-T	④	Joint (Tool Side)	1
	②	Parallel Pin $\phi 1.5 \times 4$ B Type (SUS)	2
	③	Hexagon Socket Bolt $M3 \times 0.5 \times 20$ (SUS)	2