

External Option : Resin Connector

Master Cylinder
model **SWRZ0J0-M**

Tool Adapter
model **SWRZ0J0-T**



Specifications

Rated Value (per contact)	DC 24V 2A : Pin 1,3,5,7,9,11,13,15 1A : Pin 2,4,6,8,10,12,14,16
Resin Connector	DF11-16DP-2DS(52) (HIROSE ELECTRIC)
Contact Resistance (Initial Value)	30mΩ or less
Total Current Capacity	10A
Number of Poles (per electrode)	16
Connector Pin Coating	Gold Coating
Weight ※1	Master Cylinder Side Electrode 13g
	Tool Adapter Side Electrode 11g
Cable with Applicable Connector (Sold Separately)	
SWZ0J0-CL□, SWZ0J0-M8□-CL□	

※1. Weight per electrode.

Connecting Cable

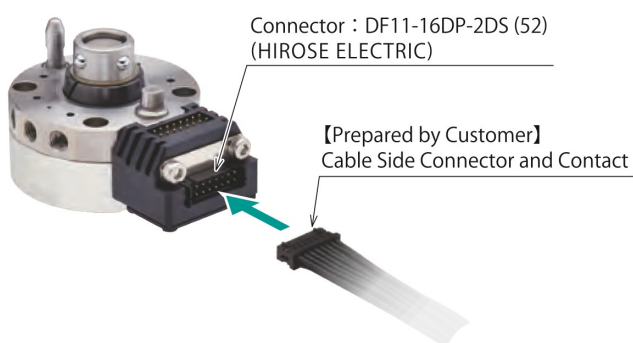

The cable side (connector, contact, cable) is not included.

Please prepare the cable with applicable connector (SWZ0J0-CL□) on P.39, or design them yourself referring to the following list.

Cable Side Connector Model No.	Cable Side Contact Model No.	Recommended Wire Size	Protective Tool		Maker
			Manual Crimping Tool	Contact Removal Tool	
DF11-16DS-2C	DF11-22SCA	AWG22	DF11-TA22HC	DF-C-PO(B)	HIROSE ELECTRIC
	DF11-2428SCA	AWG24 ~ 28	DF11-TA2428HC		

Notes : 1. Refer to HIROSE ELECTRIC catalogs for the detailed specifications and the rated current based on wire size.

2. The model number of connector required for the master cylinder and the tool adapter is the same.

External Dimensions (KWR0070/KWR0120/KWR0250/KWR0500)

Master Cylinder Side

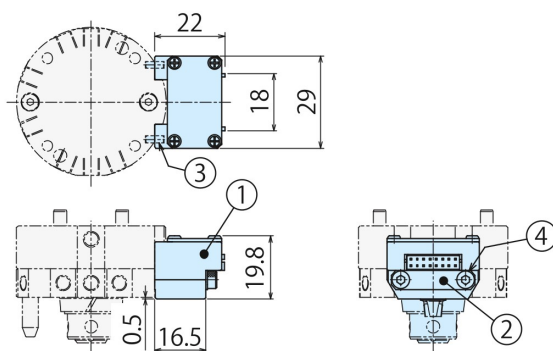

Quantity			
Model No.	No.	Name	J: 16 poles
SWRZ0J0-M	①	Electrode (Master Side)	1
	②	Spacer	1
	③	Parallel Pin $\phi 1.5 \times 4$ B Type (SUS)	2
	④	Hexagon Socket Bolt M3 $\times 0.5 \times 20$ (SUS)	2

Tool Adapter Side

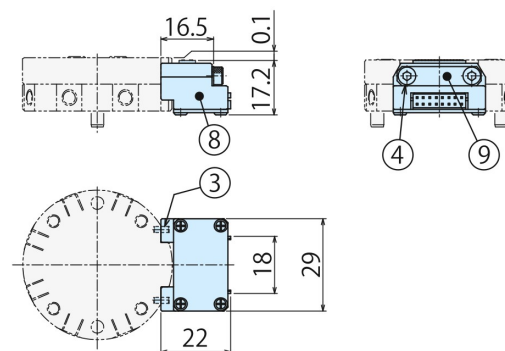

Quantity			
Model No.	No.	Name	J: 16 poles
SWRZ0J0-T	⑧	Electrode (Tool Side)	1
	⑨	Spacer	1
	③	Parallel Pin $\phi 1.5 \times 4$ B Type (SUS)	2
	④	Hexagon Socket Bolt M3 $\times 0.5 \times 20$ (SUS)	2

Notes :

1. Prepare additional mounting bolts by customer when extending another electrode. See the main unit drawing for mounting thread depth.

● External Dimensions (KWR0010)

Master Cylinder Side

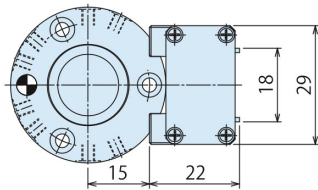

Connector (16 poles : HIROSE ELECTRIC)
DF11-16DP-2DS

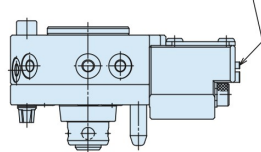

Model No.	No.	Name	Quantity
			J: 16 poles
SWRZ0J0-M	①	Electrode (Master Side)	1
	②	Spacer	1
	③	Parallel Pin $\phi 1.5 \times 4$ B Type (SUS)	2
	④	Hexagon Socket Bolt M3 \times 0.5 \times 20 (SUS)	2

Tool Adapter Side

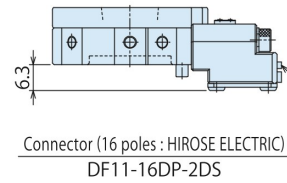

Connector (16 poles : HIROSE ELECTRIC)
DF11-16DP-2DS

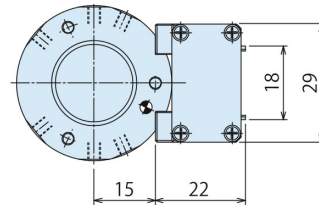

Model No.	No.	Name	Quantity
			J: 16 poles
SWRZ0J0-T	⑧	Electrode (Tool Side)	1
	⑨	Spacer	1
	③	Parallel Pin $\phi 1.5 \times 4$ B Type (SUS)	2
	④	Hexagon Socket Bolt M3 \times 0.5 \times 20 (SUS)	2

● External Option : Cable with Connector for Resin Connector

This cable is an optional cable applicable to the Resin Connector Electrode.

Model No. Indication

SWZ0J0-C **L1**
L2

Cable Length
L1 : 1m
L2 : 2m

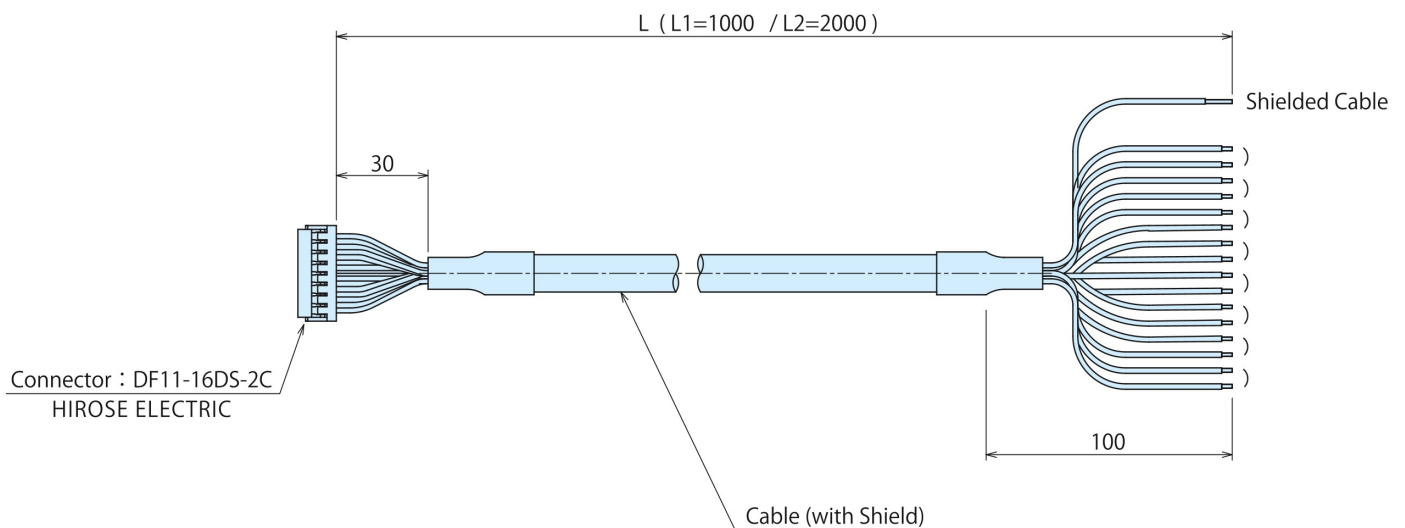

● Pin Numbers and Wire Colors

HIFLON SD-SB/20276 Black AWG24X8P (with Shield)

NISSEI ELECTRIC

Weight : 76g /m (Weight per meter)

Conductor Cross-Sectional Area : 0.2mm² (AWG24)

Number of Cores : 16



Rated Current	2A								1A							
Pin Number	1	3	5	7	9	11	13	15	2	4	6	8	10	12	14	16
Wire Color	Black	White	Red	Green	Yellow	Brown	Blue	Orange	Gray	Violet	Light Blue	Pink	White/Black	White/Red	White/Blue	Yellow/Black
	Twisted Pair		Twisted Pair		Twisted Pair		Twisted Pair		Twisted Pair		Twisted Pair		Twisted Pair		Twisted Pair	

● Note : Wire/Cable Procedure and Wiring

- Make sure to fix the wire and cable so that they are not pulled while a robot is moving or turning around.

External force should not be applied on the connector part since it leads to breaking of wire, detaching of connector and contact failure.

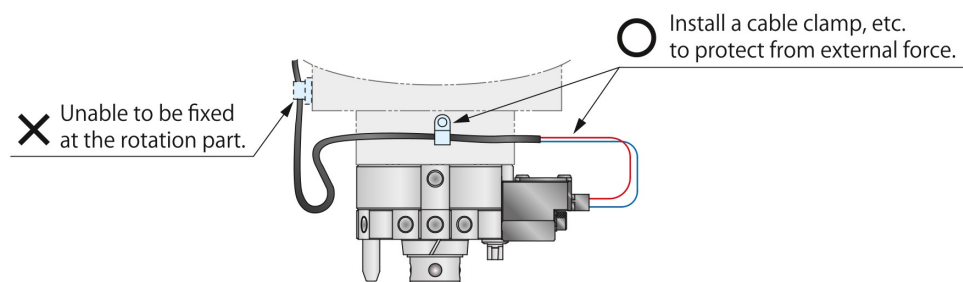

● External Option : Cable with M8 Connector for Resin Connector

This cable is an optional cable applicable to the Resin Connector Electrode.

Model No. Indication

SWZ0J0 - M8 P S - CL02 CL03

Design No.
(Revision Number)

M8 Connector Category

P : Plug

S : Socket

※ The appearance of connector is subject to change.

P : Plug

S : Socket



Cable Length

CL02 : 0.2m

CL03 : 0.3m (Only available in case of S : Socket.)

● Specifications

Rated Value	DC24V 1.5A
Connector Spec. (M8 Connector Side)	M8 Code A 8 cores (Based on IEC61076-2-104)
Weight	SWZ0J0-M8P-CL02 : 14g SWZ0J0-M8S-CL02 : 14g SWZ0J0-M8S-CL03 : 16g

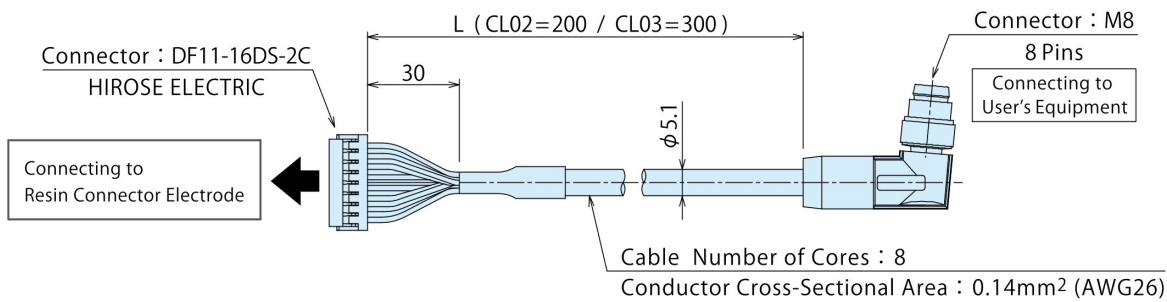

Pin Number and Wire Color	Pin Number DF11 Connector Side	Wire Color	Pin Number M8 Connector Side
	1	White	1
	3	Brown	2
	5	Green	3
	7	Yellow	4
	9	Gray	5
	11	Pink	6
	13	Blue	7
	15	Red	8

(Pin Number
2,4,6,8,10,12,14,16
Not Connected)

Pin Assignment M8 Code A

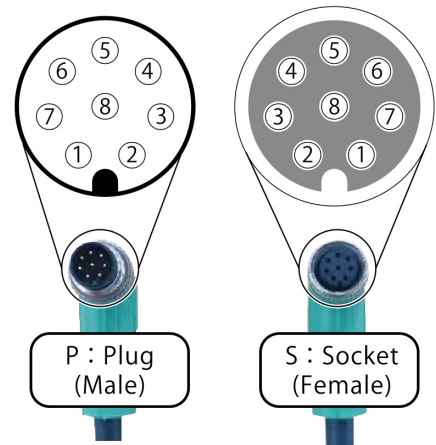

● Note

- Make sure to fix the wire and cable so that they are not pulled while a robot is moving or turning around. External force should not be applied on the connector part since it leads to breaking of wire, detaching of connector and contact failure.

✗ Unable to be fixed at the rotation part.

○ Install a cable clamp, etc. to protect from external force.

